

Generic Product Comparison

Conduit Bodies

Aluminum Conduit Bodies

Threaded for Rigid Conduit and IMC
Copper-Free Aluminum



| TYPE C-A | | | | | |
|---------------------|----------|---------------|---------|---------|------------|
| Trade Size (inches) | Appleton | Crouse-Hinds† | Killark | Red Dot | O-Z/Gedney |
| ½ | C50-A | C19 | OC-1 | AC-1 | C-50A |
| ¾ | C75-A | C29 | OC-2 | AC-2 | C-75A |
| 1 | C100-A | C39 | OC-3 | AC-3 | C-100A |
| 1¼ | C125-A | C49 | OC-4 | AC-4 | C-125A |
| 1½ | C150-A | C59 | OC-5 | AC-5 | C-150A |
| 2 | C200-A | C69 | OC-6 | AC-6 | C-200A |
| 2½ | C250-A | C789 | OC-7 | AC-7* | C-250A |
| 3 | C300-A | C889 | OC-8 | AC-8* | C-300A |
| 3½ | C350-A | C989 | OC-9 | AC-9* | C-350A |
| 4 | C400-A | C1089 | OC-10 | AC-10* | C-400A |



| TYPE LB-A | | | | | |
|---------------------|----------|---------------|---------|---------|------------|
| Trade Size (inches) | Appleton | Crouse-Hinds† | Killark | Red Dot | O-Z/Gedney |
| ½ | LB50-A | LB19 | OLB-1 | ALB-1 | LB-50A |
| ¾ | LB75-A | LB29 | OLB-2 | ALB-2 | LB-75A |
| 1 | LB100-A | LB39 | OLB-3 | ALB-3 | LB-100A |
| 1¼ | LB125-A | LB49 | OLB-4 | ALB-4 | LB-125A |
| 1½ | LB150-A | LB59 | OLB-5 | ALB-5 | LB-150A |
| 2 | LB200-A | LB69 | OLB-6 | ALB-6 | LB-200A |
| 2½ | LB250-A | LB789 | OLB-7 | ALB-7* | LB-250A |
| 3 | LB300-A | LB889 | OLB-8 | ALB-8* | LB-300A |
| 3½ | LB350-A | LB989 | OLB-9 | ALB-9* | LB-350A |
| 4 | LB400-A | LB1089 | OLB-10 | ALB-10* | LB-400A |

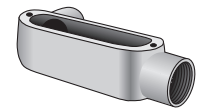

| TYPE LL-A | | | | | |
|---------------------|----------|---------------|---------|---------|------------|
| Trade Size (inches) | Appleton | Crouse-Hinds† | Killark | Red Dot | O-Z/Gedney |
| ½ | LL50-A | LL19 | OLL-1 | ALL-1 | LL-50A |
| ¾ | LL75-A | LL29 | OLL-2 | ALL-2 | LL-75A |
| 1 | LL100-A | LL39 | OLL-3 | ALL-3 | LL-100A |
| 1¼ | LL125-A | LL49 | OLL-4 | ALL-4 | LL-125A |
| 1½ | LL150-A | LL59 | OLL-5 | ALL-5 | LL-150A |
| 2 | LL200-A | LL69 | OLL-6 | ALL-6 | LL-200A |
| 2½ | LL250-A | LL789 | OLL-7 | ALL-7 | LL-250A |
| 3 | LL300-A | LL889 | OLL-8 | ALL-8 | LL-300A |
| 3½ | LL350-A | LL989 | OLL-9 | ALL-9 | LL-350A |
| 4 | LL400-A | LL1089 | OLL-10 | ALL-10 | LL-400A |

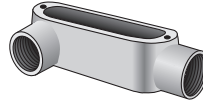

| TYPE LR-A | | | | | |
|---------------------|----------|---------------|---------|---------|------------|
| Trade Size (inches) | Appleton | Crouse-Hinds† | Killark | Red Dot | O-Z/Gedney |
| ½ | LR50-A | LR19 | OLR-1 | ALR-1 | LR-50A |
| ¾ | LR75-A | LR29 | OLR-2 | ALR-2 | LR-75A |
| 1 | LR100-A | LR39 | OLR-3 | ALR-3 | LR-100A |
| 1¼ | LR125-A | LR49 | OLR-4 | ALR-4 | LR-125A |
| 1½ | LR150-A | LR59 | OLR-5 | ALR-5 | LR-150A |
| 2 | LR200-A | LR69 | OLR-6 | ALR-6 | LR-200A |
| 2½ | LR250-A | LR789 | OLR-7 | ALR-7* | LR-250A |
| 3 | LR300-A | LR889 | OLR-8 | ALR-8* | LR-300A |
| 3½ | LR350-A | LR989 | OLR-9 | ALR-9* | LR-350A |
| 4 | LR400-A | LR1089 | OLR-10 | ALR-10* | LR-400A |

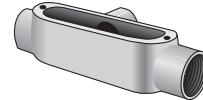

| TYPE T-A | | | | | |
|---------------------|----------|---------------|---------|---------|------------|
| Trade Size (inches) | Appleton | Crouse-Hinds† | Killark | Red Dot | O-Z/Gedney |
| ½ | T50-A | T19 | OT-1 | AT-1 | T-50A |
| ¾ | T75-A | T29 | OT-2 | AT-2 | T-75A |
| 1 | T100-A | T39 | OT-3 | AT-3 | T-100A |
| 1¼ | T125-A | T49 | OT-4 | AT-4 | T-125A |
| 1½ | T150-A | T59 | OT-5 | AT-5 | T-150A |
| 2 | T200-A | T69 | OT-6 | AT-6 | T-200A |
| 2½ | T250-A | T789 | OT-7 | AT-7* | T-250A |
| 3 | T300-A | T889 | OT-8 | AT-8* | T-300A |
| 3½ | T350-A | T989 | OT-9 | AT-9* | T-350A |
| 4 | T400-A | T1089 | OT-10 | AT-10* | T-400A |



| TYPE TB-A | | | | | |
|---------------------|----------|---------------|---------|---------|------------|
| Trade Size (inches) | Appleton | Crouse-Hinds† | Killark | Red Dot | O-Z/Gedney |
| ½ | TB50-A | TB19 | OTB-1 | -- | TB-50A |
| ¾ | TB75-A | TB29 | OTB-2 | -- | TB-75A |
| 1 | TB100-A | TB39 | OTB-3 | -- | TB-100A |
| 1¼ | TB125-A | TB49 | OTB-4 | -- | TB-125A |
| 1½ | TB150-A | -- | OTB-5 | -- | TB-150A |
| 2 | TB200-A | -- | OTB-6 | -- | TB-200A |



| TYPE X-A | | | | | |
|---------------------|----------|---------------|---------|---------|------------|
| Trade Size (inches) | Appleton | Crouse-Hinds† | Killark | Red Dot | O-Z/Gedney |
| ½ | X50-A | X19 | OX-1 | -- | X-50A |
| ¾ | X75-A | X29 | OX-2 | -- | X-75A |
| 1 | X100-A | X39 | OX-3 | -- | X-100A |
| 1¼ | -- | -- | OX-4 | -- | X-125A |
| 1½ | -- | -- | OX-5 | -- | X-150A |
| 2 | -- | -- | OX-6 | -- | X-200A |

* Red-Dot Shipped with diecast Cover † Crouse-Hinds not interchangeable with other manufacturer's covers and gaskets.